

SANI-LAV[®] COLUMBIA PRODUCTS

Large-Sized Low-Flow Industrial Nozzle with Brass Body Model N81

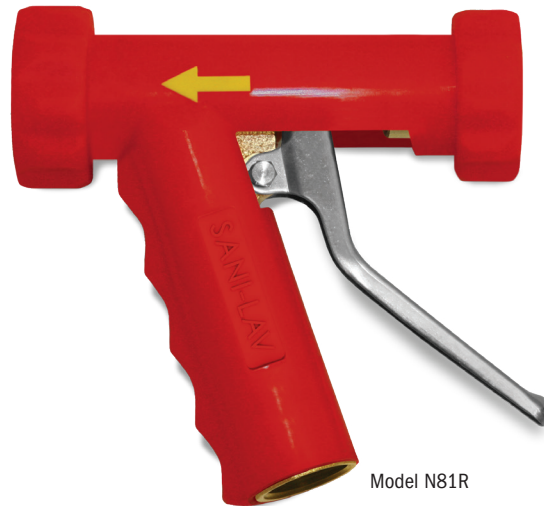

Model N81



Model N81R



Model N81W

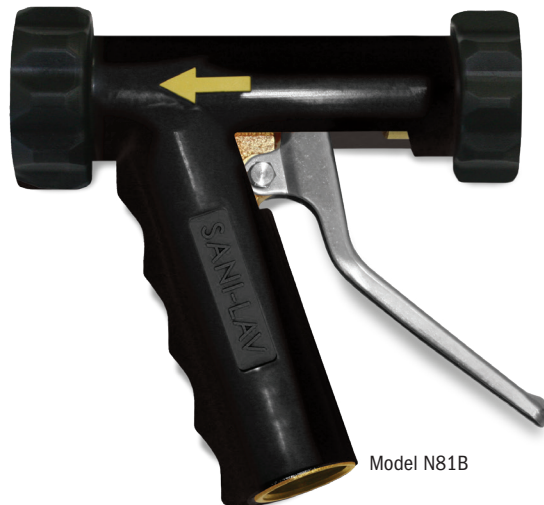

Model N81B

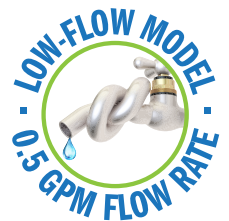

N81 Universal Features

- 3/4" GHT inlet allows direct hose connection
- Maximum working pressure 150 psi
- Maximum operating temperature: 200°F/93°C
- Weight 2.3 lbs.
- Safety shut off trigger when released
- Replaceable insulated safety orange, red, white or black covers

Model	Color	Body	Handle Type	Inlet	Max psi	Max Temp	Weight	GPM @ 100 psi	Swivel Adapter
Low Flow									
N81	Safety Orange	Brass	Stainless	3/4" FGHT	150	200	2.3	5.3 Low Flow	n/a
N81R	Red	Brass	Stainless	3/4" FGHT	150	200	2.3	5.3 Low Flow	n/a
N81B	Black	Brass	Stainless	3/4" FGHT	150	200	2.3	5.3 Low Flow	n/a
N81W	White	Brass	Stainless	3/4" FGHT	150	200	2.3	5.3 Low Flow	n/a

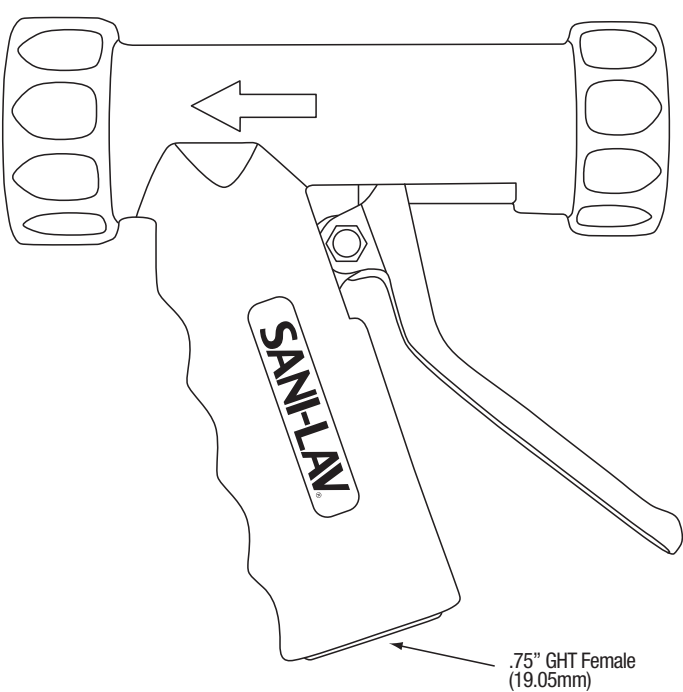

Variable Spray Nozzle

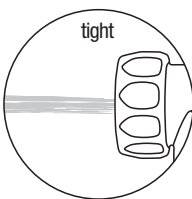
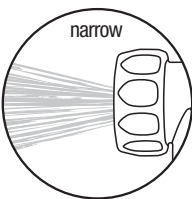
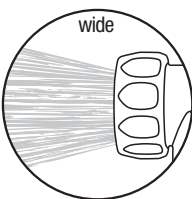

Trigger lever controls variable spray pattern

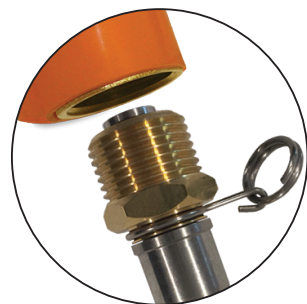

Model N20 Swivel Hose Barb
(3/4" GHT, 3/4")
Sold Separately



Model N20



Model N17 Swivel Hose Adapter
(3/4" FGHT x 3/4" MGHT)
Sold Separately

Water Flow Rate Comparison

PSI	Standard Model N8	Water Saver Model N81	Water Savings % Model N81
100	8.90 gpm	5.25 gpm	41.01%

Notice for California Consumers

 **WARNING:** This product can expose you to chemicals including Lead, and Phthalates (DEHP) which are known to the State of California to cause cancer and birth defects or other reproductive harm. For more information go to www.P65Warnings.ca.gov.

N81 Replacement Parts

Part No. Description

A	N8OC	Orange insulated cover
B	N8RC	Red insulated cover
C	N8WC	White insulated cover
D	N8BC	Black insulated cover

E	N8MB	Main body
F	N8HR	Handle replacement kit
1		Stainless steel nut
2		Stainless steel handle
3		Stainless steel handle arm sleeve
4		Stainless steel handle bolt

G	N8BR	Barrel cartridge replacement kit
5		Flow adjustment tip
6		Washer
7		Washer sleeve
8		Axle
9		Stainless steel spring
10		O-ring
11		Axle bolt
12		O-ring
13		Nut
14		Lock washer
15		Bolt
16		Viton inlet washer
H	N8E	Bolt sleeve
I	N8F	Locking nut

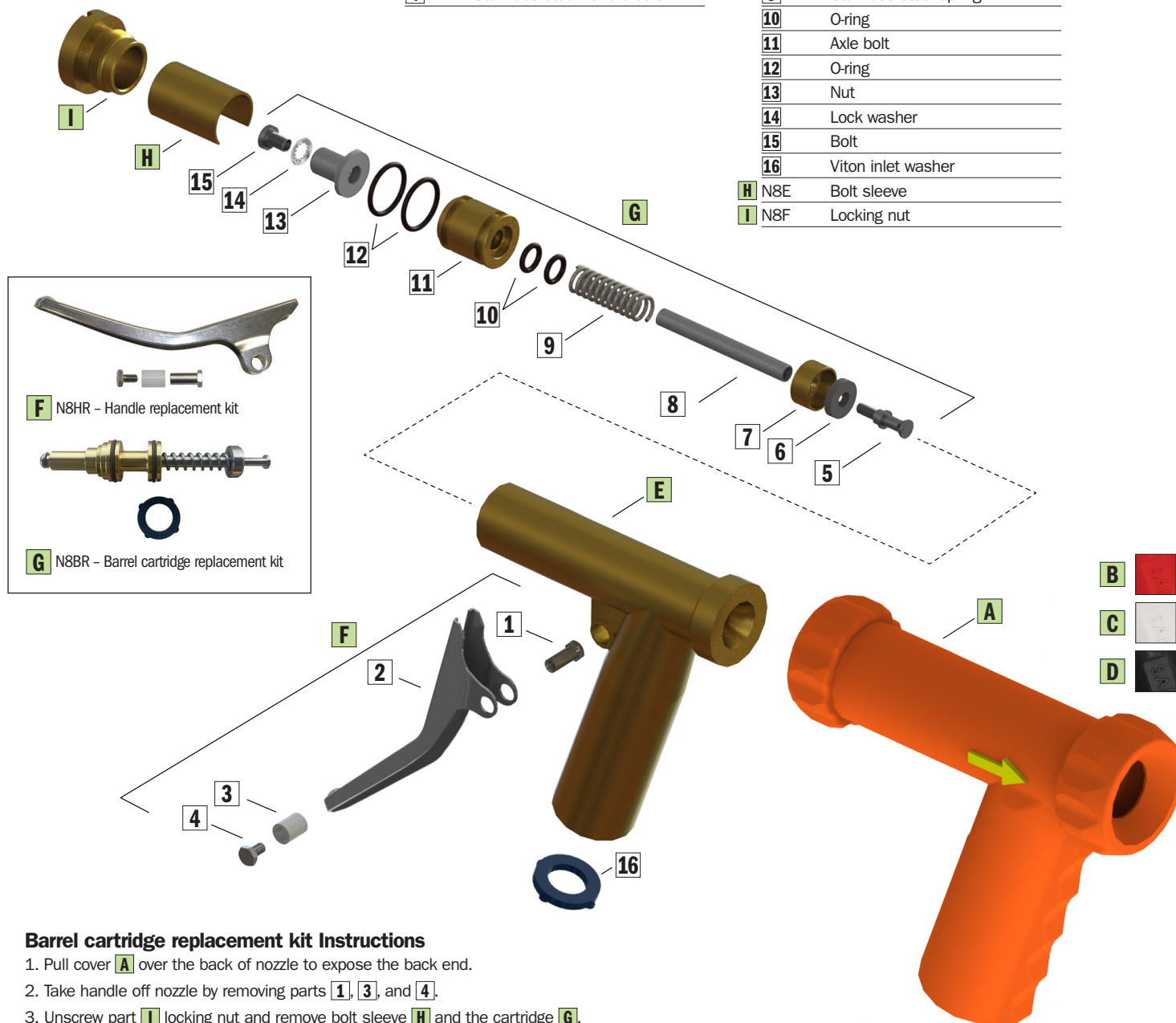

Barrel cartridge replacement kit Instructions

1. Pull cover **A** over the back of nozzle to expose the back end.
2. Take handle off nozzle by removing parts **1**, **3**, and **4**.
3. Unscrew part **I** locking nut and remove bolt sleeve **H** and the cartridge **G**.
4. Insert the new cartridge.
5. Re-Install the handle.
6. Replace the sleeve with the open end facing down.
5. Screw the locking nut back into place.
6. Slip the cover back over the nozzle end using a round ended tool similar to a shoe horn.