

COLUMBIA PRODUCTS

SANI-LAV[®]

Operating Manual for Wall Mounted Sinks Models 525FL and 525FL-0.5

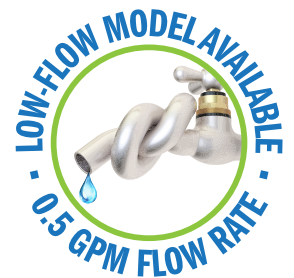

Columbia does not recommend use with harsh chemicals.
NSF/ANSI Standard 2 - Food Equipment and NSF/ANSI 372 low-lead.

Parts List

- ☐ (1) Wall mount sink
- ☐ (1) 8" on center faucet
- ☐ (1) Faucet mounting kit
- ☐ (1) Wall-mounting bracket
- ☐ (2) Support brackets
- ☐ (1) Strainer assembly with basket

Tools Required

- ☐ Tape Measure
- ☐ Adjustable Wrench
- ☐ Drill Motor and Drill Bits
- ☐ Pipe Wrench
- ☐ Level
- ☐ Safety Glasses
- ☐ Screw Drivers: 1 Phillips & 1 Standard
- ☐ Pencil
- ☐ Socket Wrench

Installation Instructions

Step 1

- Establish sink location on the wall.
- Measure a recommended 41.5" from finished floor and draw a level line which will be the top edge of the wall mounting bracket.
- Hold the wall mounting bracket against the wall and mark the wall where the holes are. Drill holes and secure bracket to the wall as shown in illustration A. Screws are not provided.

Step 2

- Install faucet assembly to the sink using the faucet mounting kit model SMK.
- Install strainer assembly at the drain hole.
- Connect hot and cold water supply (not included) to the faucet.

Step 3

- Position the sink onto wall bracket.
- Mark holes for fastening side mounting brackets as shown in illustration B.
- Remove sink from the wall bracket.
- Drill holes in wall for securing sink to wall.
- Hang sink on the wall bracket and secure to the wall.

Step 4

- Connect waste line or drain pipe to the strainer assembly.
- Connect hot and cold water supply lines to the water source.
- Remove aerator from the spout and flush water system.
- Check connections for leaks.
- Replace aerator onto the spout.

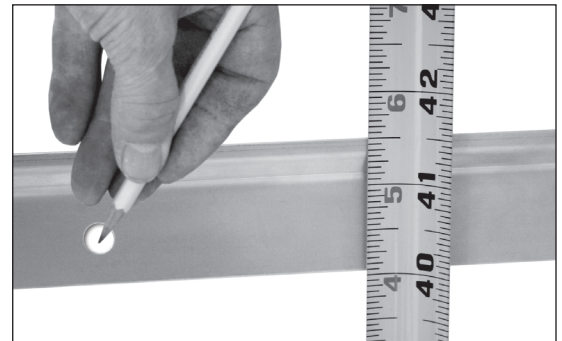

Illustration A

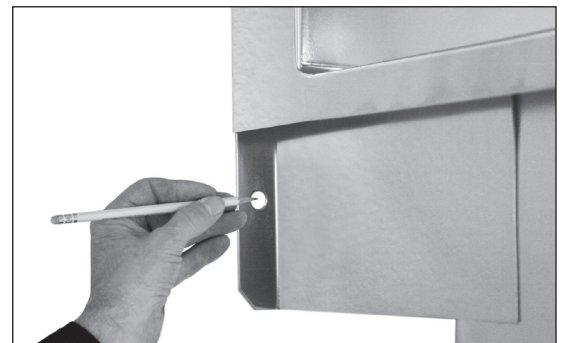

Illustration B

Trouble Shooting Guide

Problem	Possible Cause	To Diagnose	Remedy
Water drips from the spout or from under the lever.	<ol style="list-style-type: none"> 1. Seat washer is worn 2. Seat is worn 3. O-rings are worn 	Shut cold water source off. See if water still leaks from the spout. If leaks continues repair hot side if not repair cold side.	Recommend installing hot or cold faucet repair kit.

Notice for California Consumers

WARNING: This product can expose you to chemicals including Chromium (hexavalent compounds), Lead, and Phthalates (DEHP) which are known to the State of California to cause cancer and birth defects or other reproductive harm. For more information go to www.P65Warnings.ca.gov.

NOTE: Lead content originates from Brass components in valves and faucets and is certified under NSF/ANSI 372 as containing less than 0.25% lead in wetted surfaces.

COLUMBIA PRODUCTS

1622 Browning • Irvine, CA • 92606-4809 • Phone: 949.474.0777 • Toll Free: 800.626.2117 • Fax: 949.474.1191 • www.columbiasinks.com • email: info@columbiasinks.com

©2019 Columbia Products

■ Top

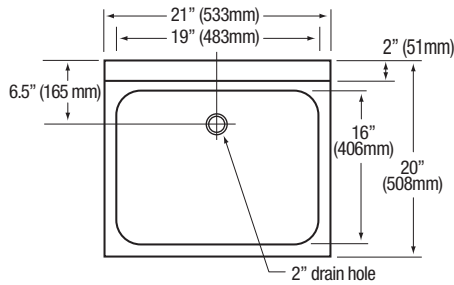

■ Front

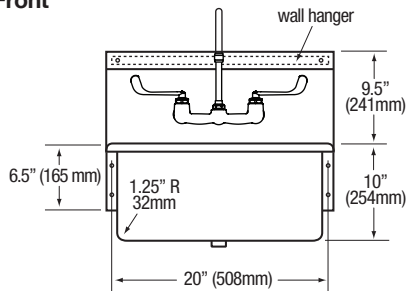

■ Side

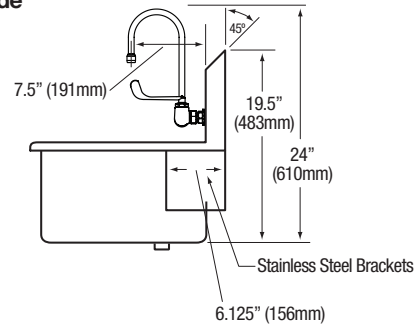

■ Hole Configurations

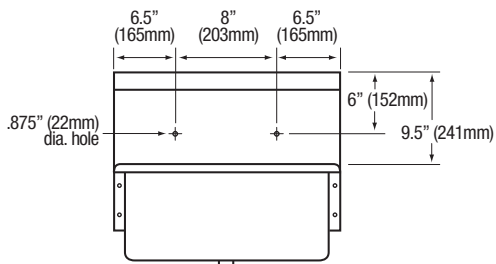

■ Wall Mounting Detail

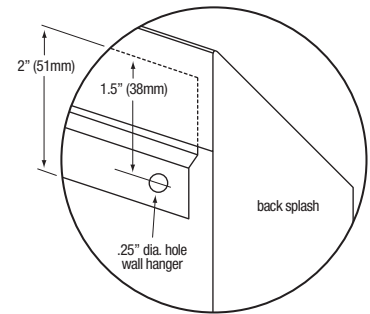

■ Supply Line Detail

