

COLUMBIA PRODUCTS

SANI-LAV[®]

Wall Mounted Surgeons Sink – Model S800

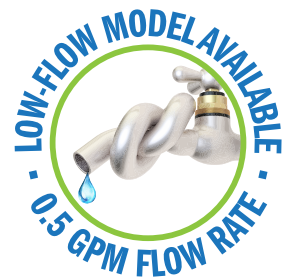

Columbia does not recommend use with harsh chemicals.
NSF/ANSI Standard 2 - Food Equipment.

Parts List

- (1) Wall mount sink
- (1) Wall-mounting bracket
- (2) Support brackets
- (1) Strainer assembly with basket

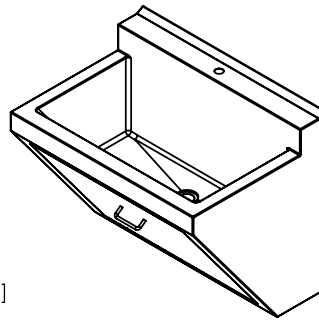
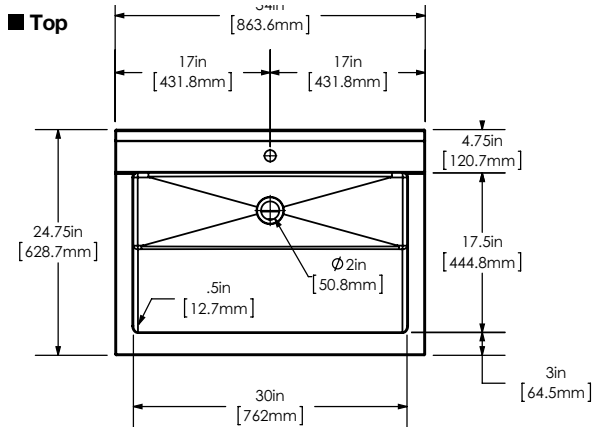

■ Wall Mounting Detail

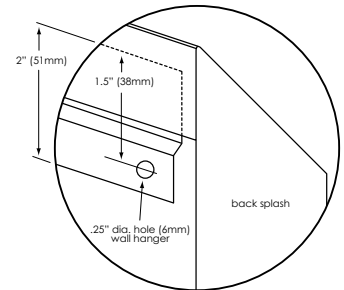

■ Front

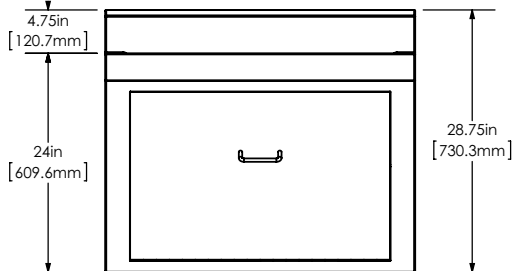

■ Side

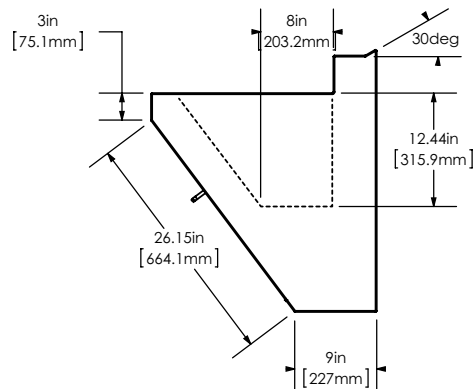

■ Hole Configuration

