

Hands-Free Stainless Steel Floor Mount Sink

| Model | Sensor Type | Flow-Rate |
|--------|-----------------|------------------|
| 725A | AC Powered | Standard 2.0 GPM |
| 725A.5 | AC Powered | Low-Flow 0.5 GPM |
| 725B | Battery Powered | Standard 2.0 GPM |
| 725B.5 | Battery Powered | Low-Flow 0.5 GPM |

Product Specifications

Hands-Free operation is ideal for use in food service applications. Built to last using 16-gauge, type 304 stainless steel. Exposed surfaces have a satin finish.

| | |
|--------------------|-------------------------------------|
| Outside Dimensions | 20" x 17-1/2" x 43-1/2" High |
| Inside Bowl Size | 17" x 14" x 7" Deep |
| Back Splash Height | 9-1/2" |
| Water Activation | AC or Battery Powered Sensor Faucet |
| Flow Rate | 2 GPM |
| Inlet Connections | 3/8" Male Compression |
| Drain Opening | 2" |
| Finish | Satin |
| Strainer | 1-1/2" Dia. Duo basket Strainer |

Includes

- (1) Floor mount sink
- (1) Leg assembly set
- (4) Washers and nuts for connection sink to leg assembly set
- (1) AC or Battery powered sensor faucet assembly
- (1) Mixing check valve
- (1) Strainer assembly with basket

Product Compliance

NSF/ANSI 2 Food Equipment
NSF/ANSI 372 Lead-Free Compliant
ASME A112.18.1



Part: _____ Quantity: _____

Project: _____

Contact: _____

Date: _____

Approval: _____

Notes:



Hands-Free Stainless Steel Floor Mount Sink
Models 725A, 725A.5, 725B and 725B.5

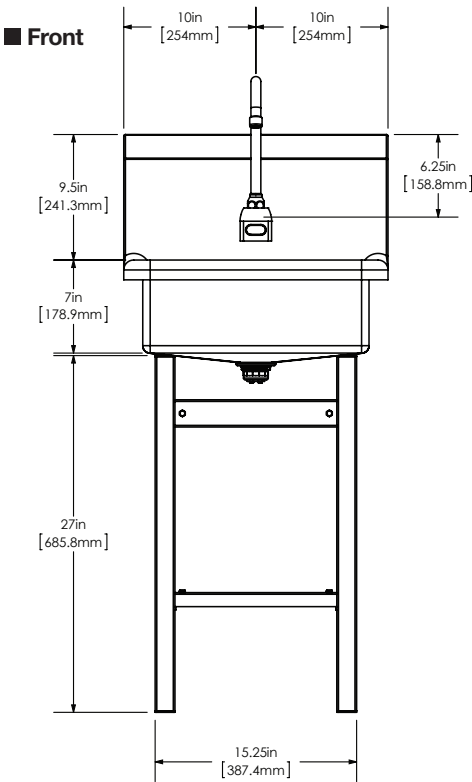
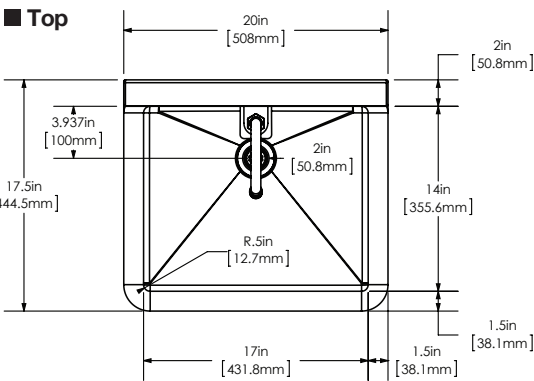

■ Hole Configuration

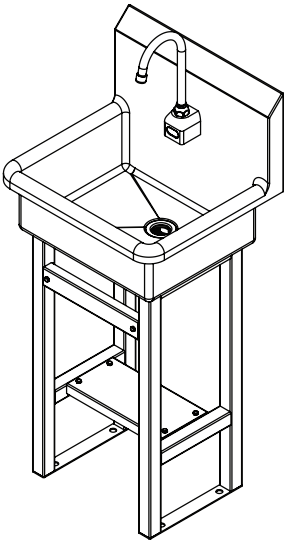
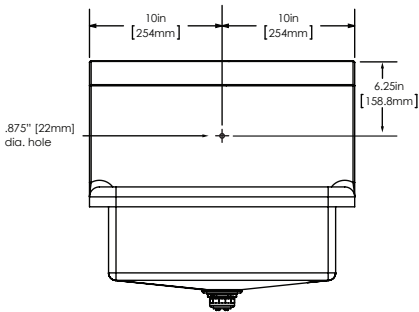

■ Side

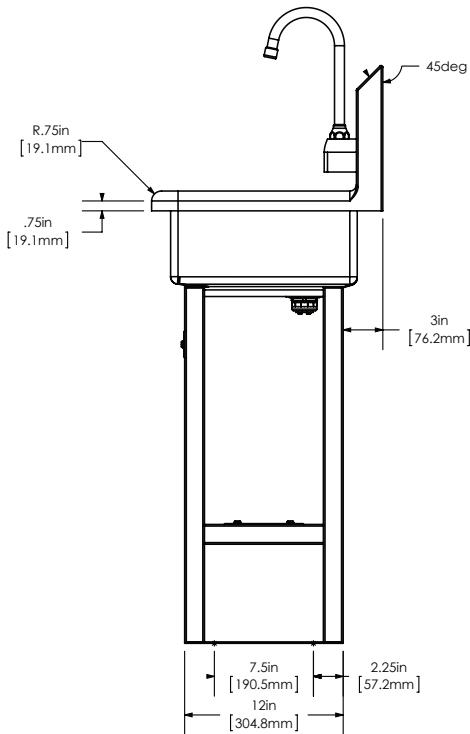

■ Floor Mounting Detail

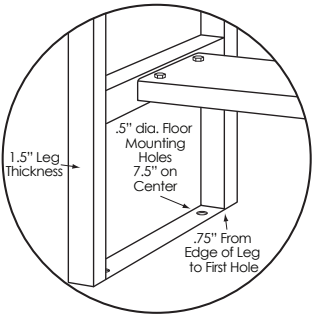

SANI-LAV Sensor Faucets

Wall Mounted AC and Battery Powered
Meets ANSI/ASME A112.18.1 M-1989



Operation

1. A continuous, invisible beam is emitted from the sensor.
2. The faucet is activated by placing hands under the spout within the effective range of the beam. Water starts to flow immediately for as long as the user's hands remain in the sensor range.
3. When hands are removed, the water flow stops. The sensor will automatically reset and be ready for the next user.
4. In the battery powered version, a flashing red light will indicate a low battery condition.

Specifications

Faucet Construction

Control Circuit

- Auto. Time-out
Solid brass, chrome plated
Solid state, AC or battery, switchable
Preset at 20 seconds and adjustable to 10, 30, or 60 seconds
- Line Purge (request only)
2 minute run every 12 hours or 24 hours
- Scrub Mode Delay (request only)
60, 120, 180 seconds
- Sensor Range
Preset and adjustable
- Shut-off Delay
Presets and adjustable from 1-8 seconds

Control Cable

Solenoid Valve

- Wattage: 0.4W (idle), 5W (in use)
- Operating Pressure: 5 psi to 125 psi

Flow Control

Armored, vandal resistant
6V DC, normally closed
2.0 or 0.5 GPM, Laminar Flow Control

AC Mode

Power Adapter

- Standard Plug-in
Input AC 120V 60 Hz or 220V
Output DC 12V, 0.8A/Class 2
- (UL/CSA)
Power Cable
Armored, vandal resistant
- Optional Multi-Unit Adapter
Serves up to 8 faucets
Input AC 120V, Output DC 12V, 3A
- (UL/CSA)

Battery Mode

Battery Powered Models

(4) AA Alkaline Batteries

Battery Service Life

400,000 on/off cycles, up to 4 years

Package Includes

- (1) Faucet with electronic sensor
- (1) Control box w/6V DC solenoid
- (1) 12V DC plug-in power adaptor (H-6700C, -DC, -LR and -LRDC only)
- (1) In-line filter with clean-out trap
- (1) 18" Flex, S.S. supply tube, 3/8"(1) 6" Gooseneck Spout
- (1) Mounting hardware
- (1) 2.0 GPM Flow Control(4) AA Alkaline batteries (HB-6700C, -DC, -LR, -LRDC only)
- (1) Battery holder (HB-6700C, -DC, -LR, -LRDC only)

Dimensions

- Base Width (Outside Measurement) 2-1/4"
- Base Depth 2-1/2"
- Faucet Height (Aerator to Base) 8-3/4"
- Faucet Height Overall 12-3/4"
- Depth (Center of Aerator to Center of Faucet Base) 5-3/8"
- Mounting Bolt Length 1-7/16"
- Mounting Bolt Pattern Single-hole mount

Optional Variations and Accessories

- 0.35, 0.5, 1.5, 2.2 GPM Laminar Flow
- HC-010 Multi-Unit Voltage Adapter (AC Powered Only) - 8 units
- HC-0104 Multi-Unit Voltage Adapter (AC Powered Only) - 4 units
- HC-001 Mixing/Check Valve (Mechanical)
- HBL-04-LR Thermostatic Mixing Valve with Checks (Low Lead)
- 8" deep Gooseneck and 6" or 8" Swing Swing SpoutModel

| Model | Sensor Type | Flow-Rate |
|-----------|-------------|------------------|
| ES2RL | AC Powered | Standard 2.0 GPM |
| ES2RL-0.5 | AC Powered | Low-Flow 0.5 GPM |

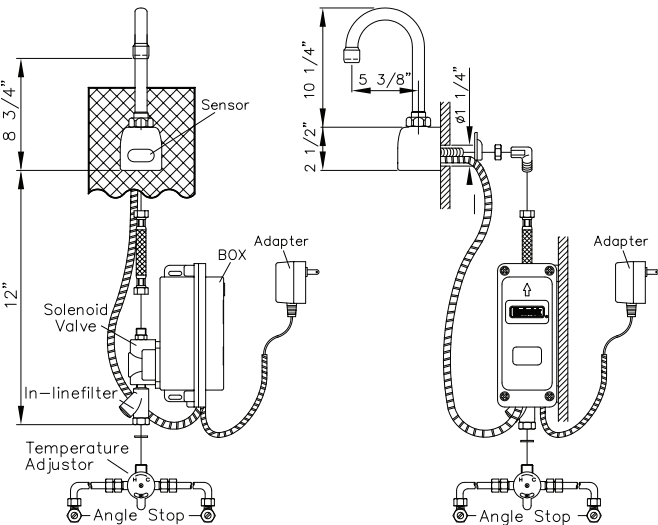

| Model | Sensor Type | Flow-Rate |
|------------|-----------------|------------------|
| ESB2RL | Battery Powered | Standard 2.0 GPM |
| ESB2RL-0.5 | Battery Powered | Low-Flow 0.5 GPM |

