

**1-Person Wall Mount
Stainless Steel Wash Station**

Model	Flow-Rate
5A1F	Standard 2.0 GPM
5A1F-0.5	Low-Flow 0.5 GPM

Product Specifications

Ideal for use in the medical and clean room applications.
Built to last using 16-gauge, type 304 stainless steel.
Exposed surfaces have a satin finish.

Outside Dimensions	30" x 20" x 15" High
Inside Bowl Size	27" x 16.5" x 5" Deep
Back Splash Height	10"
Water Activation	Manual Faucet with 4" Handles
Flow Rate	2 GPM
Inlet Connections	3/8" Male Compression
Faucet Mounting Center	8"
Faucet Mounting Holes	7/8"
Drain Opening	2"
Finish	Satin
Strainer	1-1/2" dia. Duo Basket Strainer
Wall Mounting Bracket	1/4" dia. Mounting Holes

Includes

- (1) Wall mount sink
- (1) 8" on center faucet
- (1) Faucet mounting kit
- (1) Wall-mounting bracket
- (2) Support brackets
- (1) Strainer assembly with basket

Product Compliance

NSF/ANSI 2 Food Equipment
NSF/ANSI 61, Section 9
ASME A112.18.1/CSA B125.1
ADA Compliant



Part: _____ Quantity: _____

Project: _____

Contact: _____

Date: _____

Approval: _____

Notes:

1-Person Wall Mount Stainless Steel Wash Station
Models 5A1F and 5A1F-0.5

Top

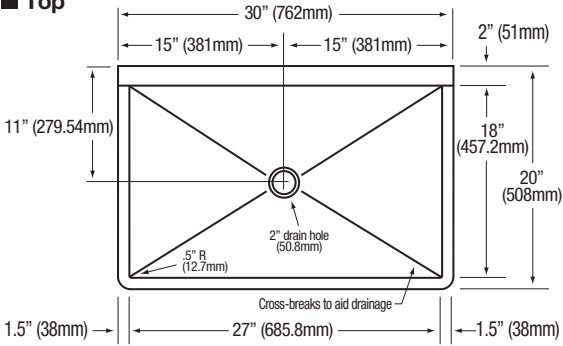

Front

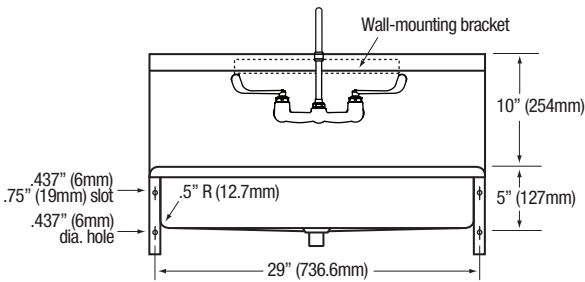

Hole Configurations

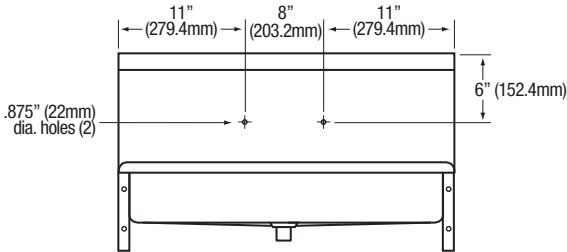

Side

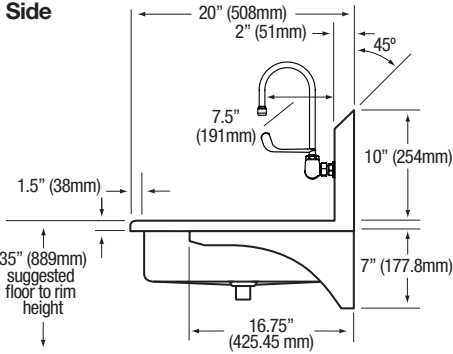

Wall Mounting Detail

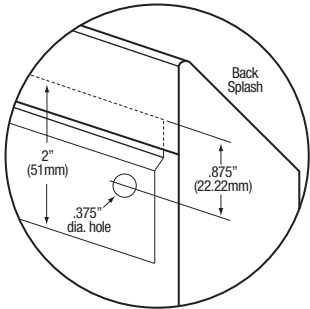

Supply Line Detail

